

PROPRIETARY INFORMATION NOTICE:
UNLESS PAYMENT HAS BEEN MADE TO ARCHITECTURE FOR PLAN DEVELOPMENT, THIS DRAWING, INCLUDING THE SPECIFICATIONS, CONCEPTS, AND DESIGNS REPRESENTED HEREIN (A) IS AND SHALL REMAIN THE PROPERTY OF ARCHITECTURE; (B) SHALL BE USED ONLY IN RELATION TO THE SPECIFIC PROJECT FOR WHICH IT HAS BEEN PREPARED; (C) SHALL NOT BE COPIED, DISCLOSED TO THIRD PARTIES, USED TO ENABLE OTHERS TO PERFORM OR COMPLETE THIS PROJECT, OR USED IN CONJUNCTION WITH ANY WORK OR PROJECT OTHER THAN THE SPECIFIC PROJECT FOR WHICH IT HAS BEEN DEVELOPED

FIELD DIMENSIONS MUST BE VERIFIED PRIOR TO INSTALLATION WHEN THIRD PARTY INSTALLERS ARE USED

CLIENT SIGN OFF:

X

DATE:

CLIENT SIGNATURE CONSTITUTES A COMPLETE UNDERSTANDING AND APPROVAL OF THE PRODUCT SPECIFICATIONS AND FINISHES REPRESENTED HEREIN. NO FURTHER CHANGES OR MODIFICATIONS WILL APPLY WITHOUT CLIENT APPROVAL AND SIGNATURE

FINISHES:

- PANELS:*
- WORKSURFACES:*
- UNDER SURFACE STORAGE:*
- FREESTANDING STORAGE:*
- BINS / SHELVES:*
- POWER:*

3D IMAGES PROVIDED FOR ILLUSTRATION PURPOSE ONLY



4 PARK PLAZE, SUITE 100
IRVINE, CA 92614
P: 714.831.6323 F: 714.825.4625
www.catalystoffice.com

PROJECT NOTES:

DRAWING SCALE: 3/16" = 1'-0" SALES/RSN SHEET #

START DATE: DESIGNER_ID

PROJECT #: 17173

1
2

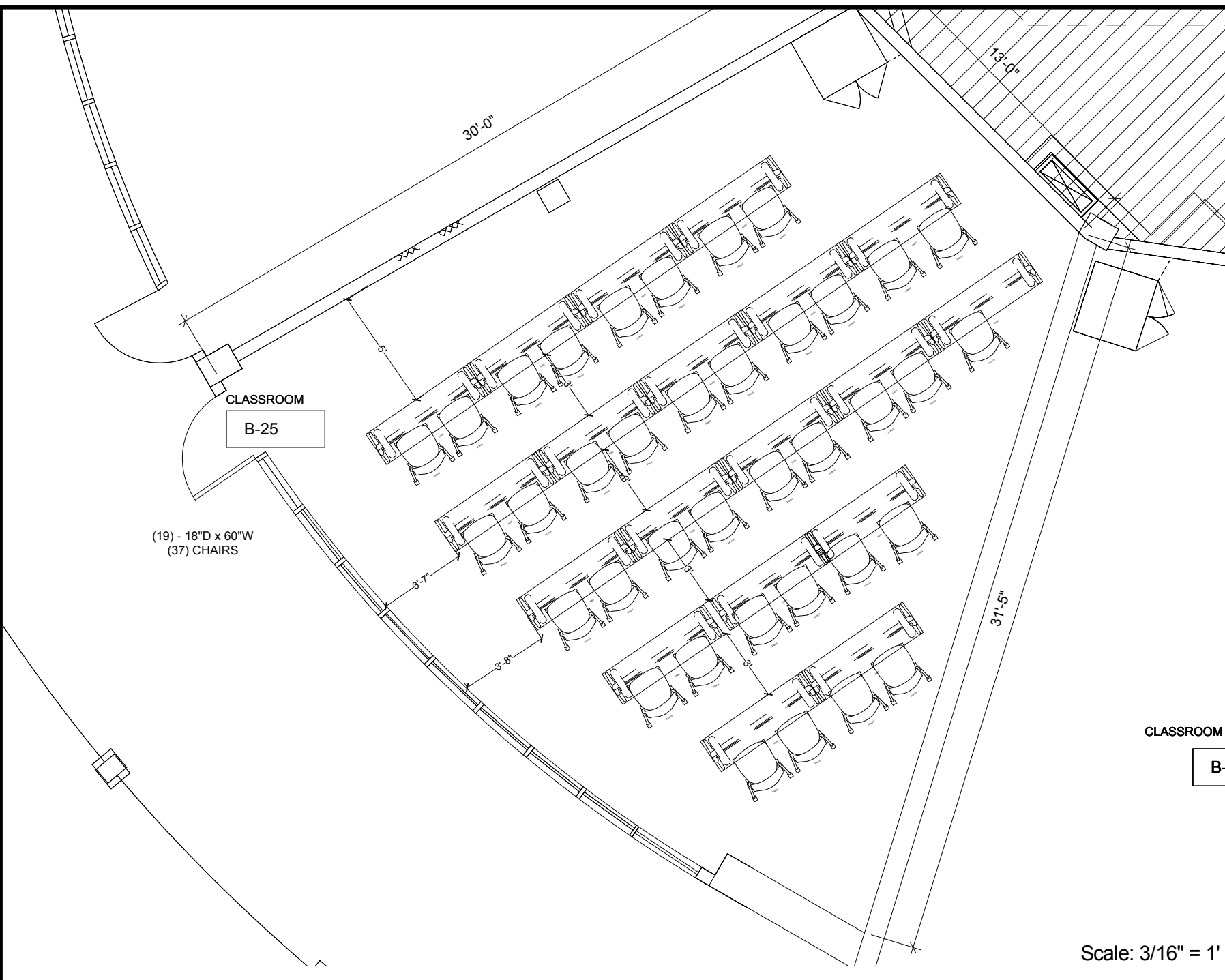

(19) - 18"D x 60"W
(37) CHAIRS

CLASSROOM
B-25

CLASSROOM
B-

Scale: 3/16" = 1'

Plot Date: 02/12/2018

FURNITURE PLAN: CLAREMONT MCKENNA COLLEGE PROPOSED PLAN

Drawing Name / Scope: Classroom Bauer 2nd Floor - (19)18x60 TABLES(37)chairs

Install Plan

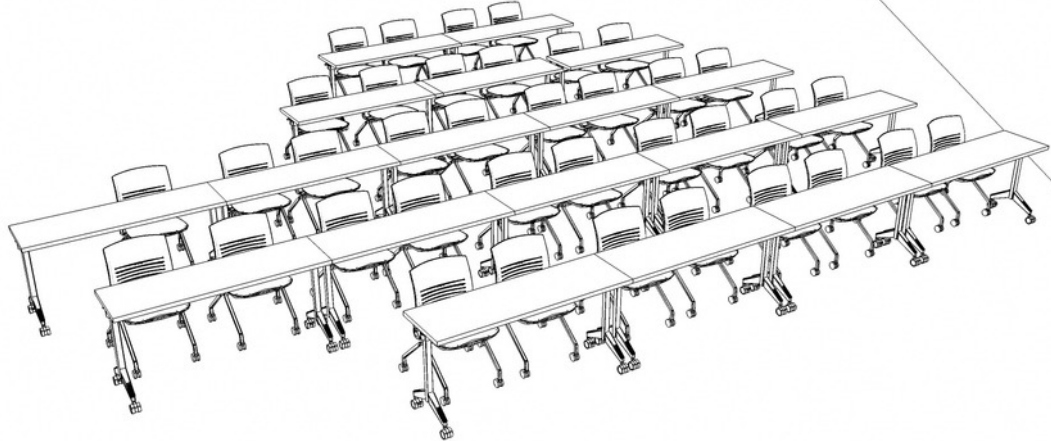

CATALYST
A Steelcase Dealer

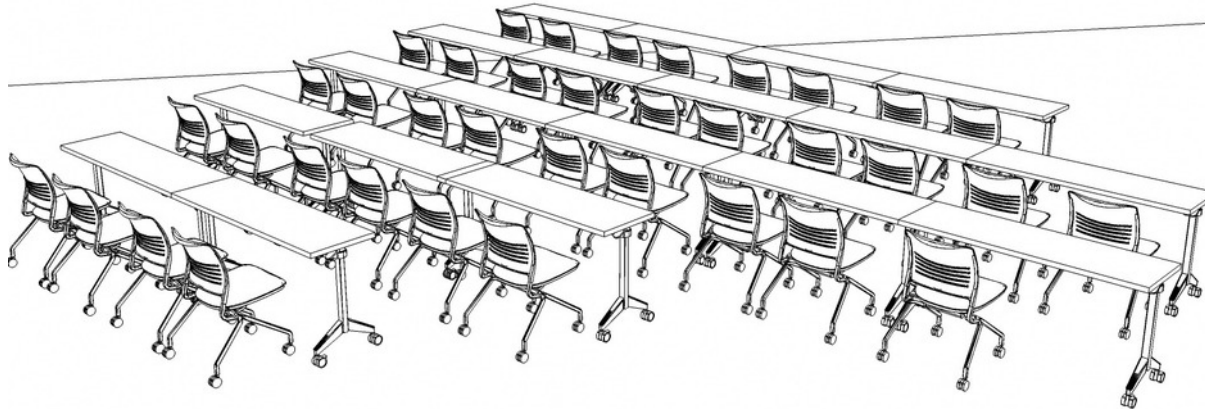

CATALYST
A Steelcase Dealer

PROPRIETARY INFORMATION NOTICE:
UNLESS PAYMENT HAS BEEN MADE TO
ARCHI.TXTURE FOR PLAN DEVELOPMENT,
THIS DRAWING, INCLUDING THE
SPECIFICATIONS, CONCEPTS, AND
DESIGNS REPRESENTED HEREIN (A) IS
AND SHALL REMAIN THE PROPERTY OF
ARCHI.TXTURE; (B) SHALL BE USED ONLY
IN RELATION TO THE SPECIFIC PROJECT
FOR WHICH IT HAS BEEN PREPARED; (C)
SHALL NOT BE COPIED, DISCLOSED TO
THIRD PARTIES, USED TO ENABLE
OTHERS TO PERFORM OR COMPLETE
THIS PROJECT, OR USED IN
CONJUNCTION WITH ANY WORK OR
PROJECT OTHER THAN THE SPECIFIC
PROJECT FOR WHICH IT HAS BEEN
DEVELOPED

*FIELD DIMENSIONS MUST BE VERIFIED
PRIOR TO INSTALLATION WHEN THIRD
PARTY INSTALLERS ARE USED*

CLIENT SIGN OFF:

X

DATE:

*CLIENT SIGNATURE CONSTITUTES A
COMPLETE UNDERSTANDING AND
APPROVAL OF THE PRODUCT
SPECIFICATIONS AND FINISHES
REPRESENTED HEREIN. NO FURTHER
CHANGES OR MODIFICATIONS WILL APPLY
WITHOUT CLIENT APPROVAL AND
SIGNATURE*

FINISHES:

PANELS:

WORKSURFACES:

UNDER SURFACE
STORAGE:

FREESTANDING
STORAGE:

BINS / SHELVES:

POWER:

*3D IMAGES PROVIDED FOR
ILLUSTRATION PURPOSE ONLY*

CATALYST
A Steelcase Dealer

4 PARK PLAZE, SUITE 100
IRVINE, CA 92614
P: 714.831.6323
F: 714.825.4655
www.catalystoffice.com

PROJECT NOTES:

DRAWING SCALE: SALES:RN SHEET #

3/16" = 1'-0"

START DATE: DESIGNER_ID

2
2

PROJECT #: 17173

FURNITURE PLAN: CLAREMONT MCKENNA COLLEGE PROPOSED PLAN

Plot Date: 02/12/2018

Drawing Name / Scope: Classroom Bauer 2nd Floor - (19)18x60 TABLES/(37)CHAIRS

Install Plan